

GK1300 Series Electric Strike Installation Instructions

Features

- Heavy duty stainless steel construction (US 32D)
- Vertical adjustments allow for alignment with a wide variety of mortise locks with offset latches
- Sliding keeper shim design for up to 1/8" (3mm) adjustment for misaligned frames
- Accommodates deadbolts up to 1"
- Field selectable for fail-safe or fail-secure
- Non-handed design fits either right-handed or left-handed doors
- Trim plate included
- Optional latch monitor SW1300 (for GK1300M) - Indicates when door is latched (The maximum input rating for SW1300M is 1.5A/40VDC)
- Includes 5 different stainless steel faceplates

UL Requirements

- For indoor use only.
- Wiring methods shall be in accordance with NFPA 70.
- The GK1300 series is intended to be used with UL Listed Exit Hardware.
- The GK1300 series shall not impair the intended operation of an emergency exit.
- The GK1300 series shall not impair the operation of panic hardware mounted on the door.

Specifications

Operating Voltage	12VDC, 24VDC, 12/24VDC
Current Draw	Single Voltage: 250mA/12VDC or 150mA/24VDC Dual Voltage: 300mA/12VDC, 150mA/24VDC
Operating Temp.	14°F to 120°F (-10°C to 49°C)
Humidity	0-85% non-condensing
Latch Throw	1" (25mm) max with 1/8" (3mm) door gap
Static Strength	1000 lbs (454Kg)
Dynamic Strength	33 ft-lbs
Endurance Rating	250,000 cycles (UL tested) 1,000,000 cycles (Factory tested)
Performance Level	Destructive Attack: Level I Line Security: Level I Standby Power: Level I Endurance: Level IV

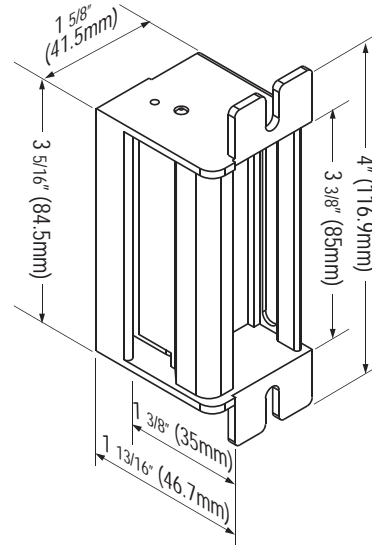

Options	12 or 24 VDC	12/24 VDC	Latch Monitor (SW1300)
Part Number			
GK1300-12	•		
GK1300-24	•		
GK1300-1224		•	
GK1300M-12	•		•
GK1300M-24	•		•
GK1300M-1224		•	•

Wiring Instructions

12 or 24 VDC Wiring Diagram

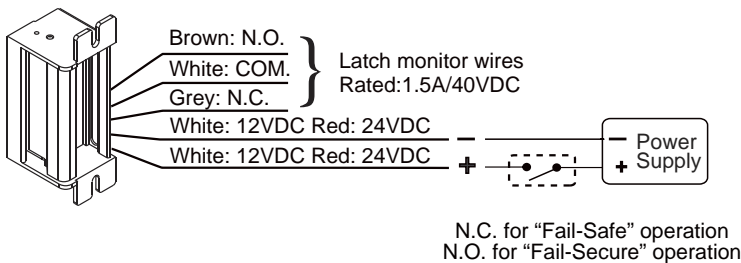

12/24 VDC Wiring Diagram

For 12VDC Operation:

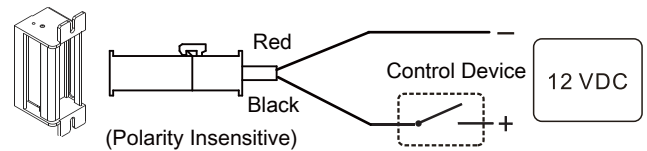

For 24VDC Operation:

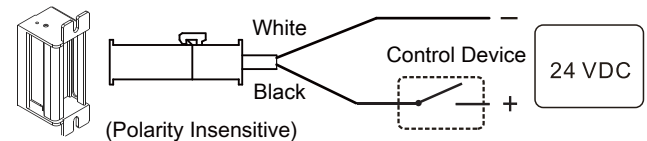

Fail-Safe/ Fail-Secure Reversible

Fail-secure or fail-safe is field selectable by changing position of screws as shown.

1. Loosen and remove the locking screw.
2. Loosen and move the sliding screw to the desired setting, and replace/retighten both screws.

Note: Factory default setting is fail-secure.

Fail-Safe:



Fail-Secure:

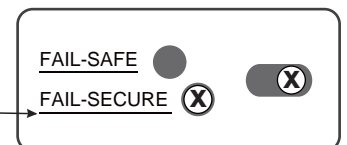

GK1300 Series Faceplates Dimensions

Deadbolt Latch Installation

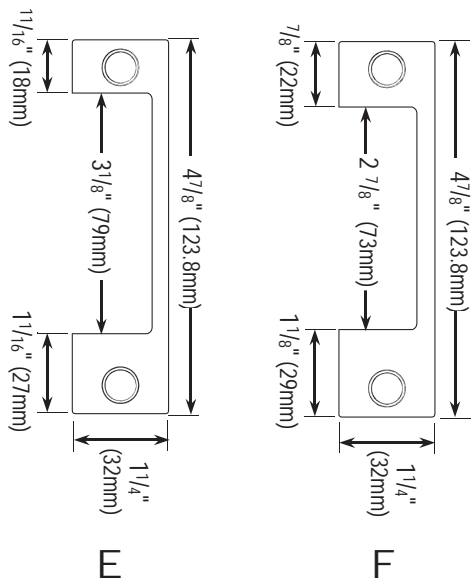

Latchbolt Installation

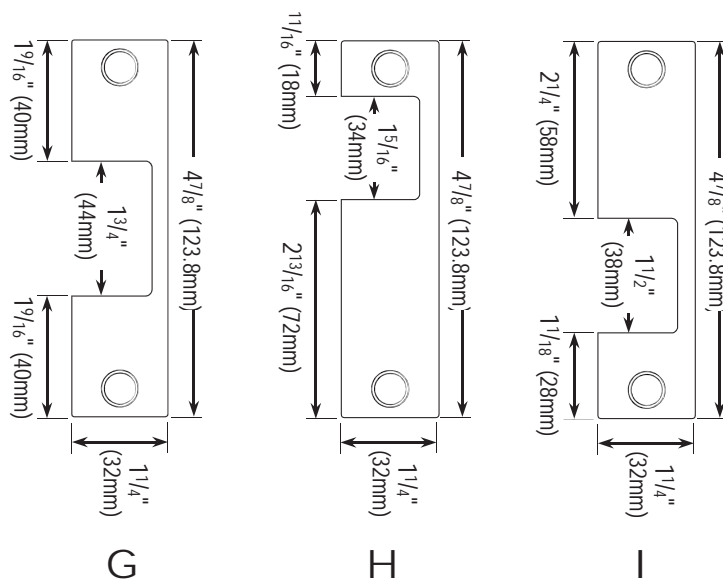

Note: If it is necessary to cut a hole in the frame, mounting tabs maybe required to strengthen the installation.

Mounting the Strike Using Mounting Tabs

The mounting tabs are only used for aluminum and metal door frames. This is commonly done when retrofitting door frames.

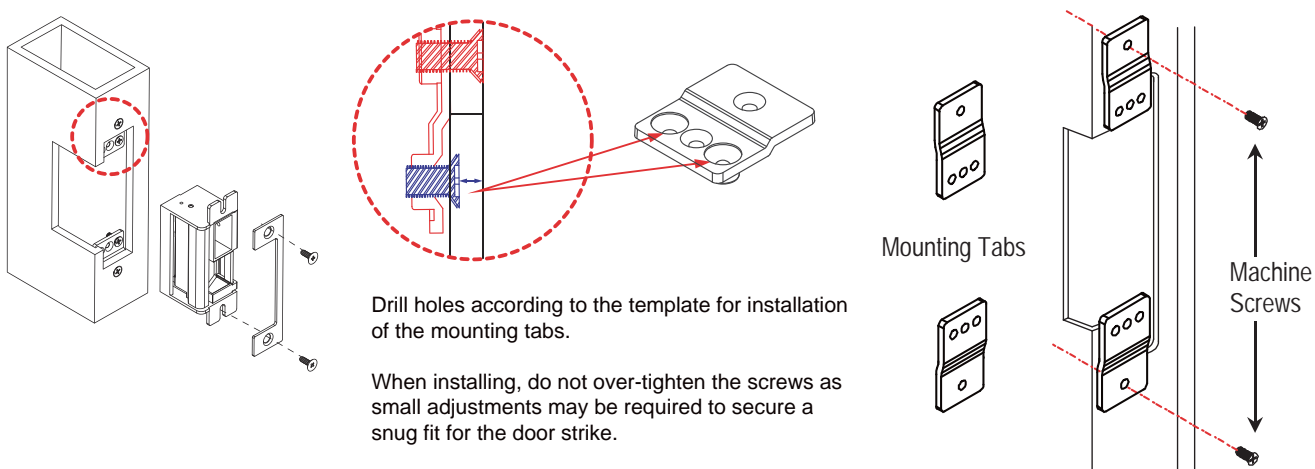

Mounting the Trim Plate

1. If the hole cut for the faceplate is too large or is jagged, the trim plate can be mounted over the hole to improve the appearance of the installation.
2. Screw the trim plate into the mounting holes at the top and bottom of the door strike using the included trim plate screws before installing the strike to the door frame.

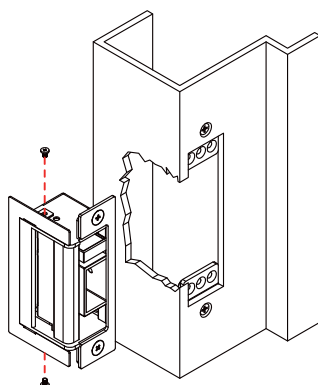

Installing the Crimp Connectors

Crimp connectors are provided to make wiring connections easier and more reliable. To install the connectors:

1. Insert the wires into the connector.
2. Use a crimping tool or pliers to evenly press down on the head of the connector.

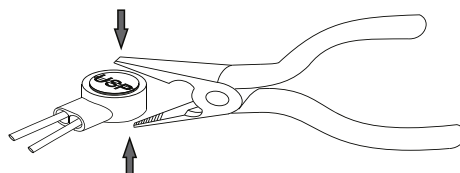

Sticker Template Instruction

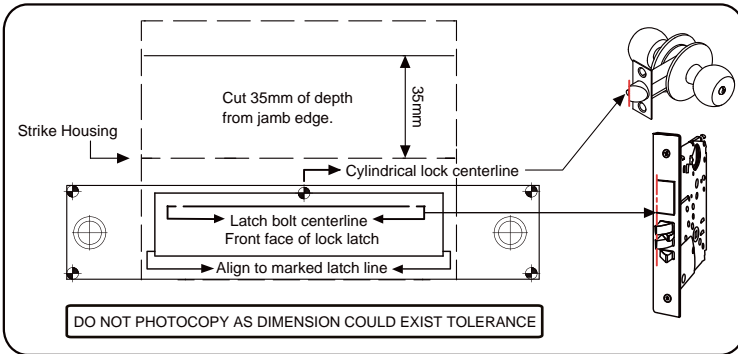

Refer to the supplied template. Verify lock compatibility and determine the reference line on the template.

Electric Strike Adjustment

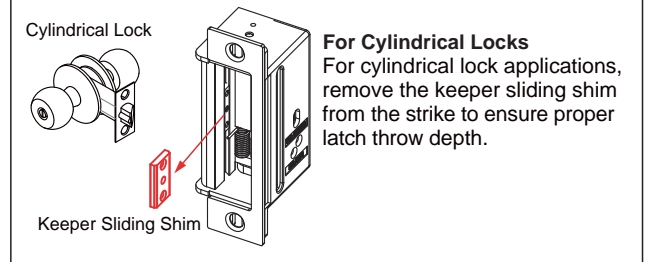
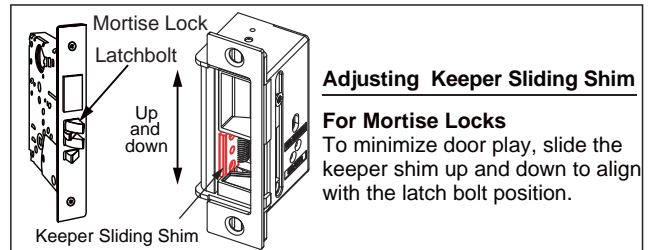
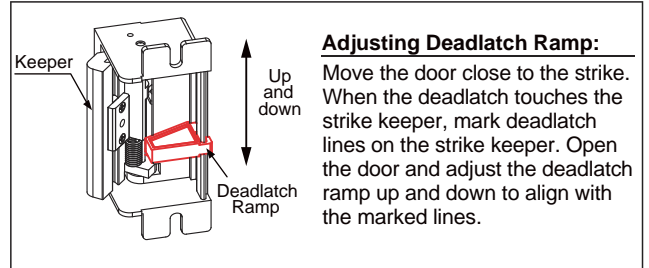
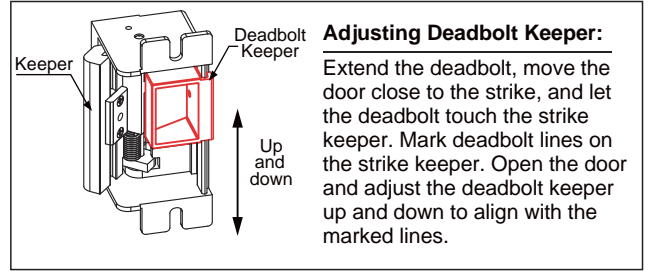

Electric Strike Installations

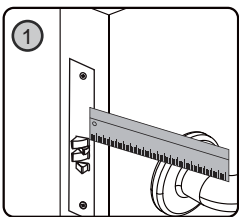

1 Measure latch position and mark on the frame.

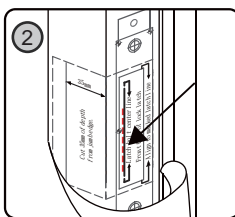

2 Attach the template to the frame and align the reference line with the marked line.

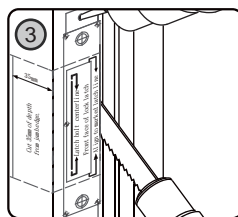

3 Drill and cut the frame according to the template.

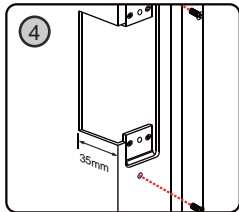

4 Fasten the mounting tabs to the frame.

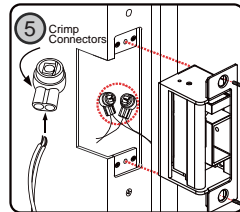

5 Connect the wires using the crimp connectors, then test the strike, ensure to give it correct voltage.

Note:

Proper gap must be reserved between the strike keeper and latch bolt to prevent solenoid valve failure.

Optional Latch Monitor SW1300 Installations

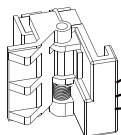

Brown: N.O.
White: COM.
Grey: N.C.

Latch monitor wires
Rated: 1.5A/40VDC

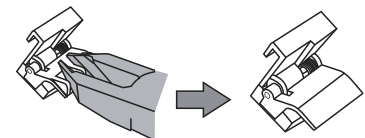

Test the door to make sure that the latch depresses the latch monitor lever. If not, trim the 3 ribs on the lever using side cutters.

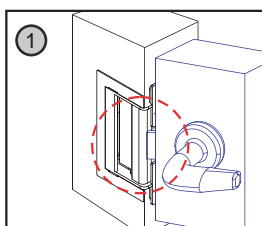

1 Move the door towards the strike.

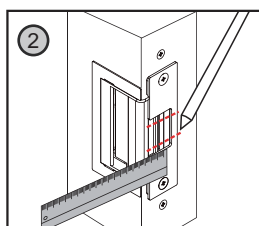

2 Mark latch limit lines on the keeper.

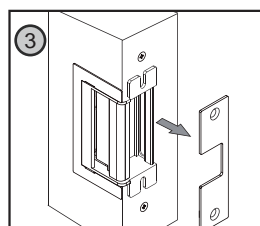

3 Remove the strike.

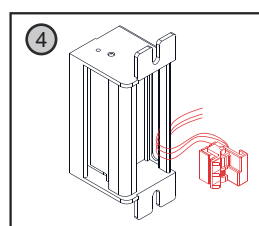

4 Mount the SW1300 (latch monitor) and align with the marked lines on the keeper.

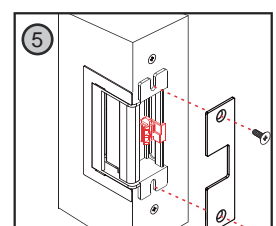

5 Test to see if any adjustment is necessary.