

Electric Strike Installation Instructions

GK370/371 Series

The GK370/371 series electric strikes are designed to accommodate cylindrical locksets with up to 9/16" (15mm) latch throw. GK370/371 feature horizontal faceplate adjustment up to 7mm (1/4"). The strikes can be configured to fail-safe or fail-secure on site. Standard models are made with zinc alloy while available in stainless steel for enhanced durability.

Specifications

Operating Voltage	12/24VDC
Current Draw	300mA/12VDC, 150mA/24VDC
Operating Temperature	32°F to 120°F (0°C to 49°C)
Humidity	0% to 85% Non-condensing
Latch Throw	9/16"(15mm) 1/2"(12mm) strike depth, 1/8"(3mm) door gap
Keeper Width	1 7/16" (37mm)
Static Strength	1500 lbs (680Kg)
Endurance	1,000,000 cycles (Factory tested)

Model	Latch Monitor	Body Construction
GK370-1224	—	Zinc Alloy
GK370-ST-1224	—	Stainless Steel
GK370M-1224	●	Zinc Alloy
GK370M-ST-1224	●	Stainless Steel
GK371-1224	—	Zinc Alloy
GK371-ST-1224	—	Stainless Steel
GK371M-1224	●	Zinc Alloy
GK371M-ST-1224	●	Stainless Steel

Compatible Locksets

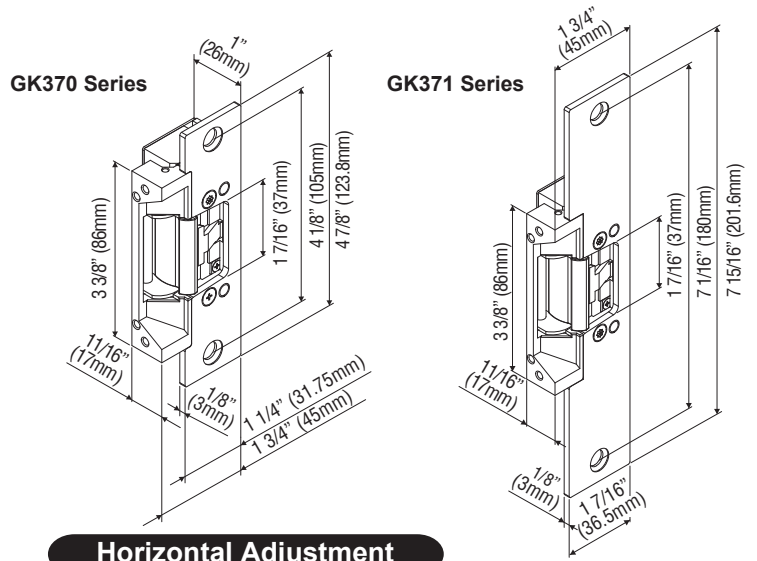
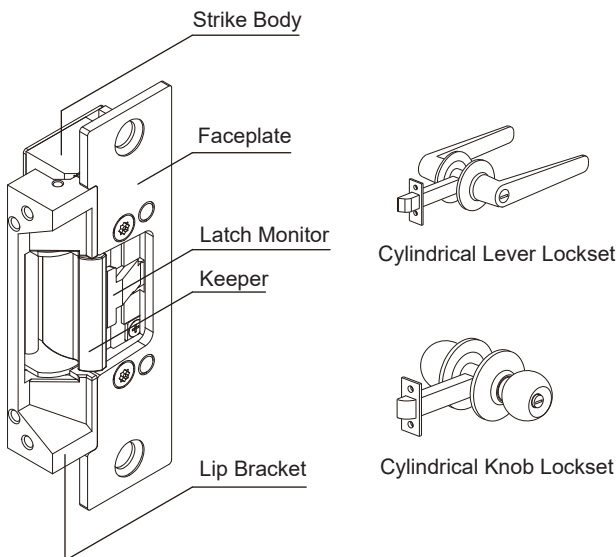

Horizontal Adjustment

Loosen the adjustment screws and shift the lip bracket to the proper horizontal position (7 mm range adjustable). Tighten the adjustment screws and secure the lip bracket with the set screws.

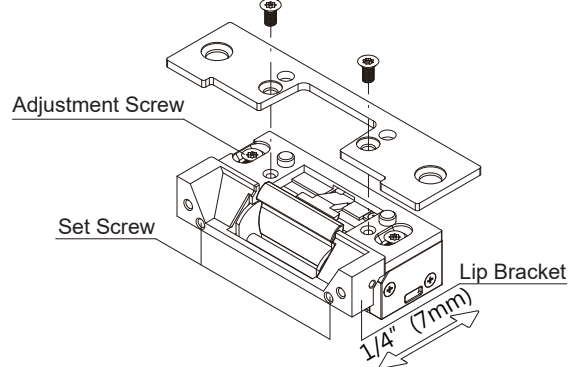

Frame Application

Wood Frame Installation

Hollow Metal Frame Installation

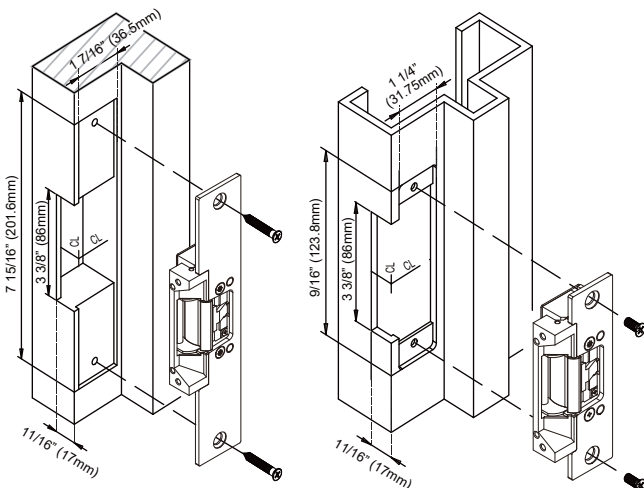

Fail-Safe / Fail-Secure Reversible

Change screw position at fail-safe /fail-secure hole to the desired setting.

Fail-Safe:

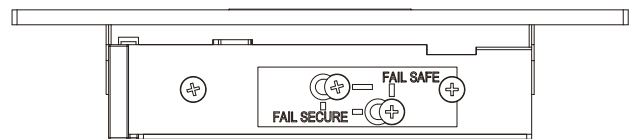

Fail-Secure:

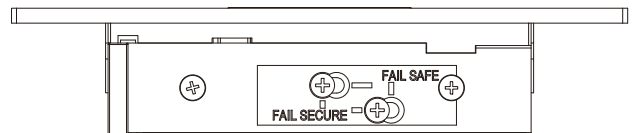

Installation Instructions

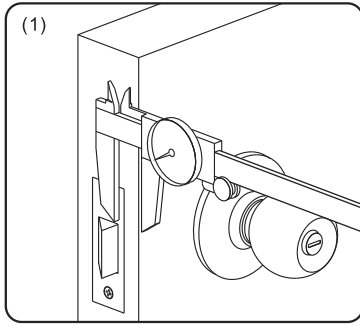

Measure latch position

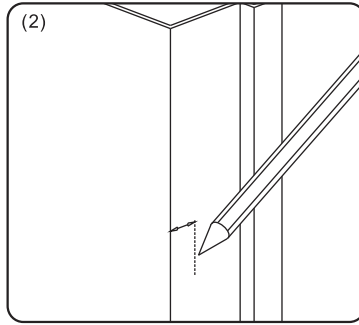

Mark latch position line

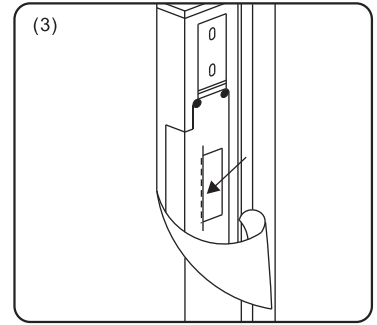

Attach sticker template to marked centerline

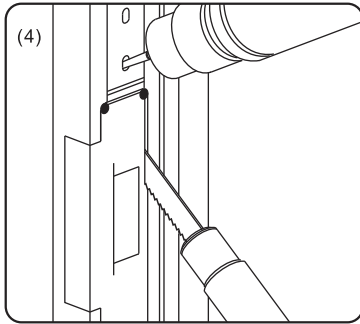

Cut hole using template

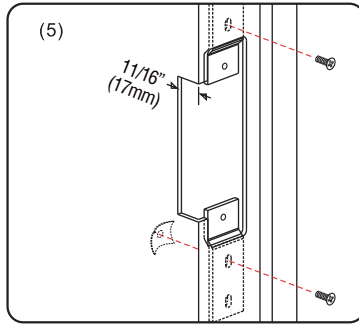

Install the mounting tabs

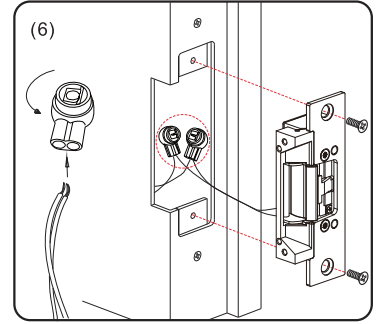

Connect the wires using the crimp connectors, then test the strike, ensure to give it correct voltage.

Caution:

Proper gap must be reserved between the strike keeper and latch bolt to prevent failure of solenoid valve.

Connecting Diagram

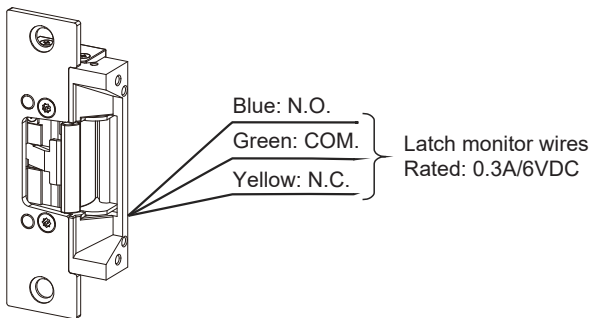

Latch Monitor

N.O. dry contact output:
opened status
N.C. dry contact output:
When the micro switch is
pressed by latch bolt

12/24 VDC Plug-In Wiring

For 12VDC Operation:

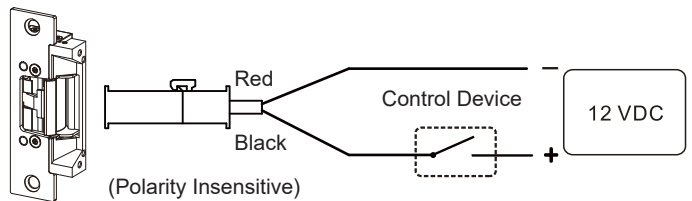

For 24VDC Operation:

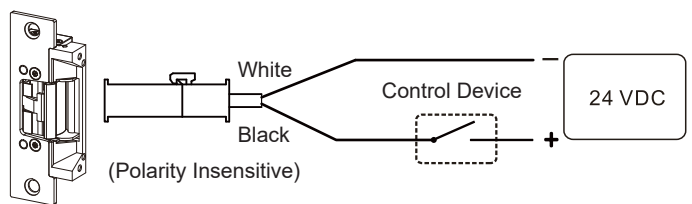

Optional Brackets

Lip extension brackets are available for wider jambs.

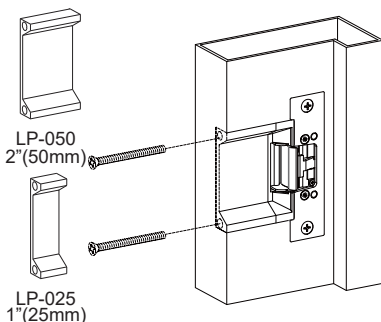

Using the Trim Plate

In case of over-cutting, use the enclosed trim plate to cover up any errors.

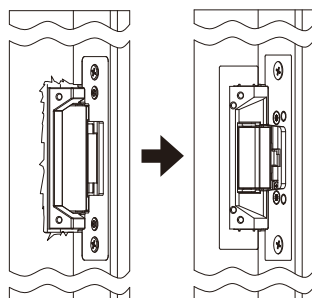

Installing the Crimp Connectors

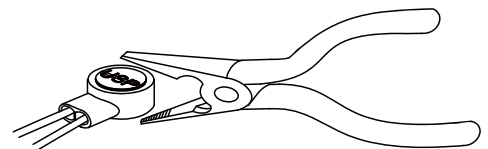

Crimp connectors are provided to make wiring connections easier and more reliable. To install the connectors:

1. Insert the wires into the connector.
2. Use a crimping tool or pliers to evenly press down on the head of the connector.