

General Purpose Key Switch

Description:

Install Key Switch in the outside (as the figure) and parallel (or series) connect with the power supply and electromagentic lock. If the electromagentic lock is not opened for the reasons of that the proximity reader is out of order or that unexpected accident happens, please switch the contacts by the key to compel the fail-safe(Power to Lock) or fail-secure(Power to Open) electromagentic lock to be opened. This is a precaution of the access control system.



KS-700W
(ANSI size)
Mortise type key switch.
(maintained SPDT or momentary SPDT).

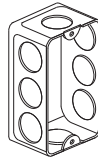

ANSI Box

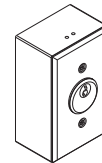

KS-700WS / KS-700WSW
(Surface Mount)
Surface mounted with SMB-700 housing.
(with vandal proof screws)

SPDT figure

Momentary (or Maintained) SPDT

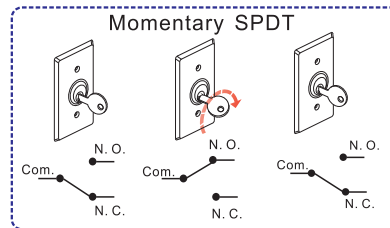
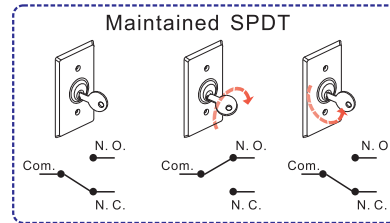
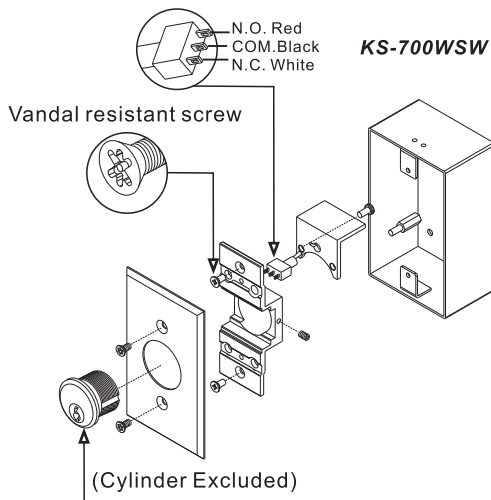

Application

The connection for fail-safe lock devices :

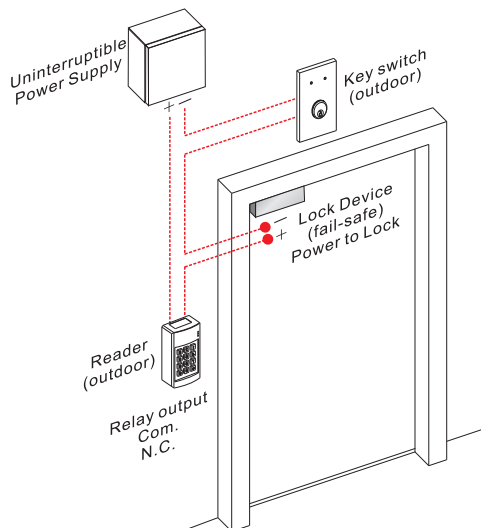

The connection for fail-secure lock devices :

