

Key Switches

Simple Solution for Exit, Door Release,
Mechanical Override or Reset



ANSI Standard Key Switch
Fits ANSI standard single-gang
electrical boxes



European Standard Key Switch
Fits Euro standard single-gang
electrical boxes



Narrow Stile Key Switch
Ideal for narrow mullion
application

GEM key switches are often used to control electric locks, shunt or activate security panels, or any similar requirements. They are compatible virtually with any system, and offer a secure and economic access control for a variety of applications.

Standard Features

- Easy to install and maintain
- Stainless steel faceplate
- SPDT, DPDT or 3PDT
- Momentary or alternative (maintained) switch available

Standard Options

- 12 to 24VDC Red & Green LEDs
- Stainless steel or metal surface back box
- Key cylinder with keys

Warranty

The product is warranted against defects in material and workmanship while used in normal service for a period of 1 year from the date of sale to the original customer. The GEM policy is one of continual development and improvement; therefore GEM reserves the right to change specifications without notice.

Alternate (Maintained) Action

Turning the key left or right actuates and latches the contact. Contact position is maintained until the key is inserted and turned again.

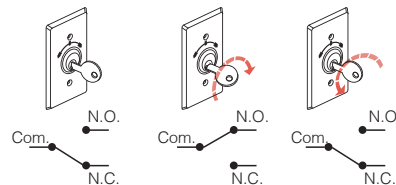

Momentary Action

Turning the key left or right momentarily actuates the contact.

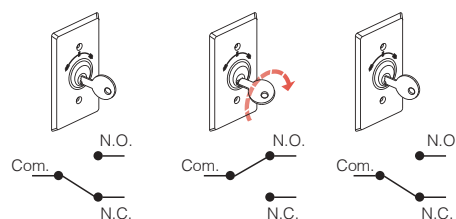

ANSI Standard Key Switches

Models	Switch Rating	Contact	Switch Type	Options		
				Back Box	LED	Cylinder & Keys
KS-500	16(4)A/250VAC	SPDT	Momentary	●	—	●
KS-700W	5A/125VAC	SPDT	Momentary or Alternate (Maintained)	●	—	●
KS-750	5A/125VAC	SPDT or DPDT	Alternate (Maintained)	●	●	●
KS-780	5A/125VAC	3PDT or DPDT	Alternate (Maintained)	●	●	●
KS-790	5A/125VAC	3PDT or DPDT	Momentary	●	●	●

Note: For KS-750, SPDT switch model comes with LED.

Dimensions

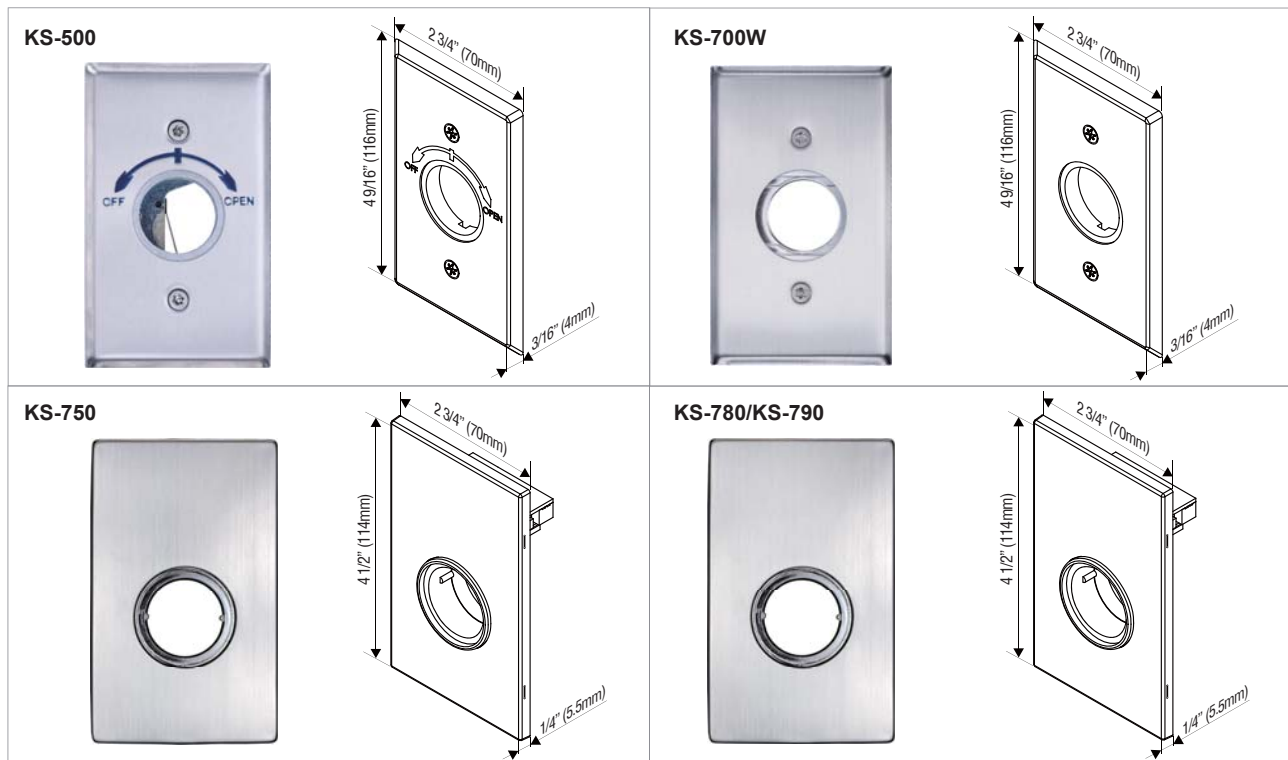

Optional Accessories

 <p>SMB-050 Stainless steel back box, 4 9/16" x 2 3/4" x 1 3/4," Silver (116 x 70 x 45mm) For KS-500/700W</p>	 <p>SMB-750 Aluminum back box, 4 1/2" x 2 3/4" x 1 3/16," White (114 x 69.7 x 30mm) For KS-750/780/790</p>	 <p>S-BT-KS Mortise key cylinder and keys For KS-500/750/780/790</p>	 <p>P-BT-KS-700 Mortise key cylinder and keys For KS-700W</p>
---	--	---	---

European Standard Key Switches

Models	Switch Rating	Contact	Switch Type	Options		
				Back Box	LED	Cylinder & Keys
KS-7510A	4A/125VAC	SPDT	Momentary		—	Included
KS-800	5A/125VAC	SPDT or DPDT	Alternate (Maintained)	●	●	●
KS-810	5A/125VAC	SPDT or DPDT	Momentary	●	●	●
KS-860	5A/125VAC	SPDT	Momentary or Alternate (Maintained)	●	●	●

Note: For KS-800/810, SPDT switch model comes with LED.

Dimensions

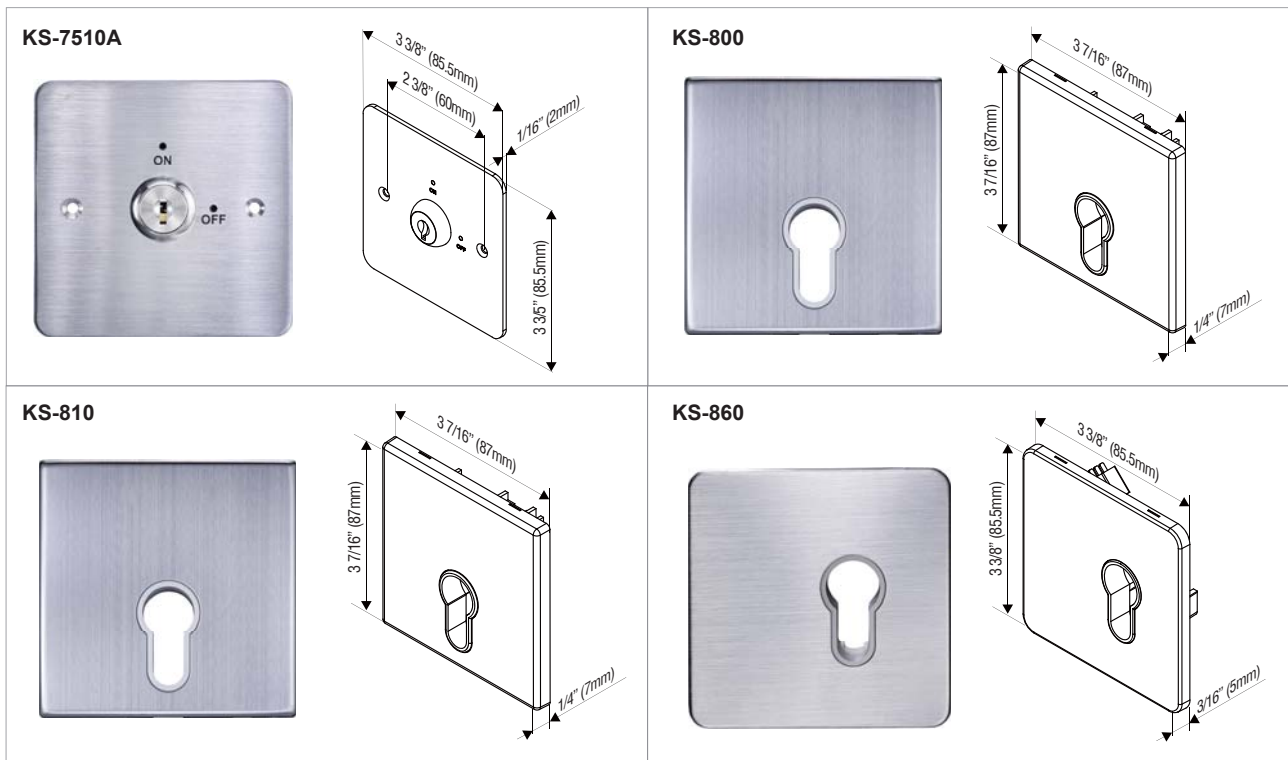

Optional Accessories

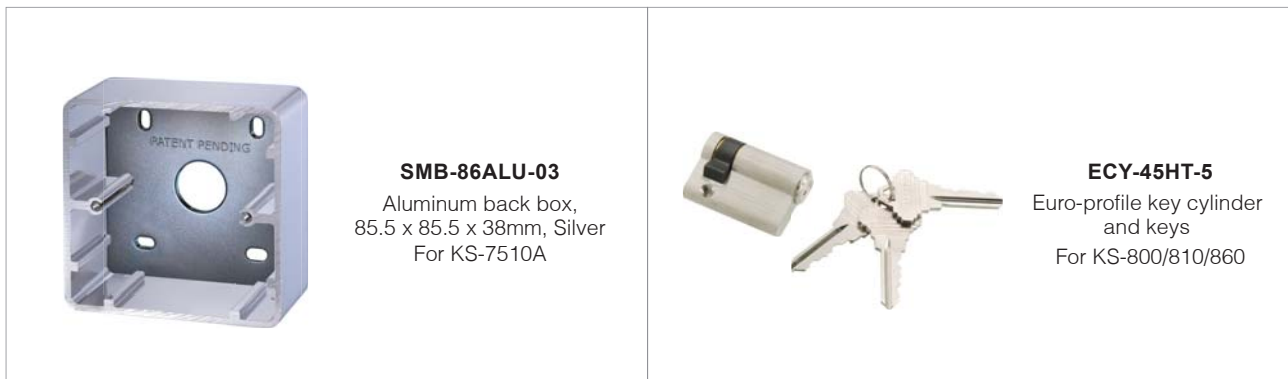

SMB-86ALU-03
Aluminum back box,
85.5 x 85.5 x 38mm, Silver
For KS-7510A

ECY-45HT-5
Euro-profile key cylinder
and keys
For KS-800/810/860

Narrow Stile Key Switches

Models	Switch Rating	Contact	Switch Type	Options		
				Back Box	LED	Cylinder & Keys
KS-900	5A/125VAC	SPDT or DPDT	Alternate (Maintained)	●	●	●
KS-910	5A/125VAC	SPDT or DPDT	Momentary	●	●	●

Note: SPDT switch model comes with LED.

Dimensions

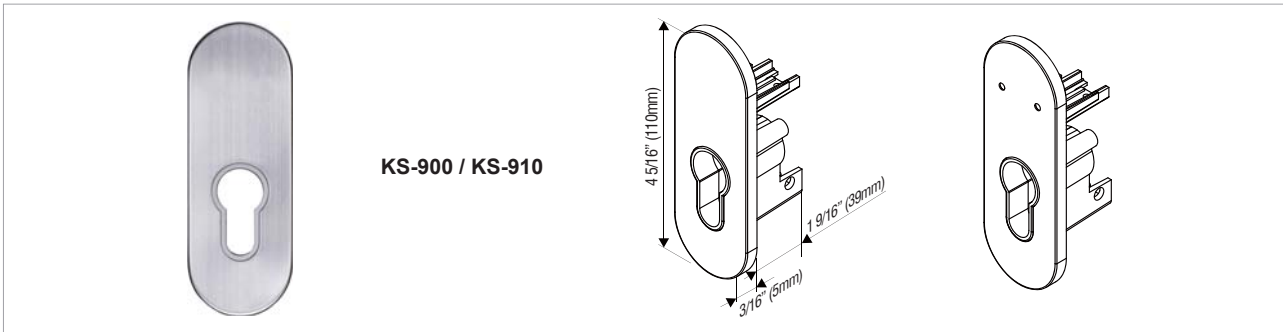

Optional Accessories



Applications

GEM key switch assemblies offer an economic solution for a variety of access control applications.

Connection to fail-safe locking devices

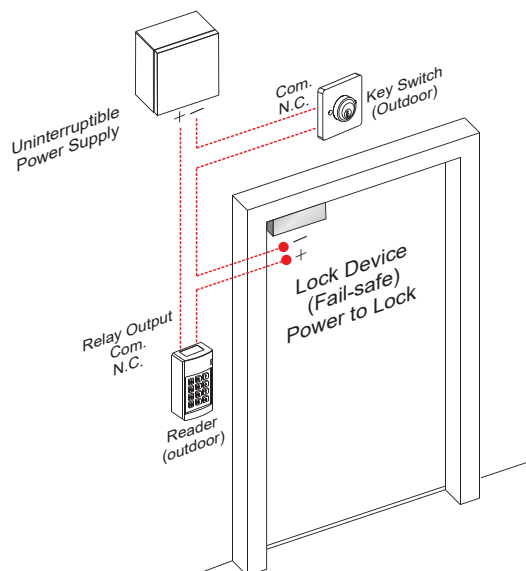

Connection to fail-secure locking devices

